

WIND DRIVEN MOTORCYCLE ASSEMBLY INSTRUCTIONS & MAINTENANCE

Part No Style
961107-WG Brush Finish
961107-WGB Black

Bill of Materials

- (1) Wind Driven Motorcycle
- (1) Handlebars
- (1) Stand, Base
- (1) Stand, Stem
- (2) Fan Blade
- (4) Button Head Screws
& 3/32 Allen Wrench
- (1) Button Head Screws
& 3/16 Allen Wrench
- (1) Nylon Washer

ASSEMBLE HANDLEBAR ASSEMBLY WITH
(4) BUTTON HEAD SCREWS
(USE 3/32" ALLEN WRENCH PROVIDED)

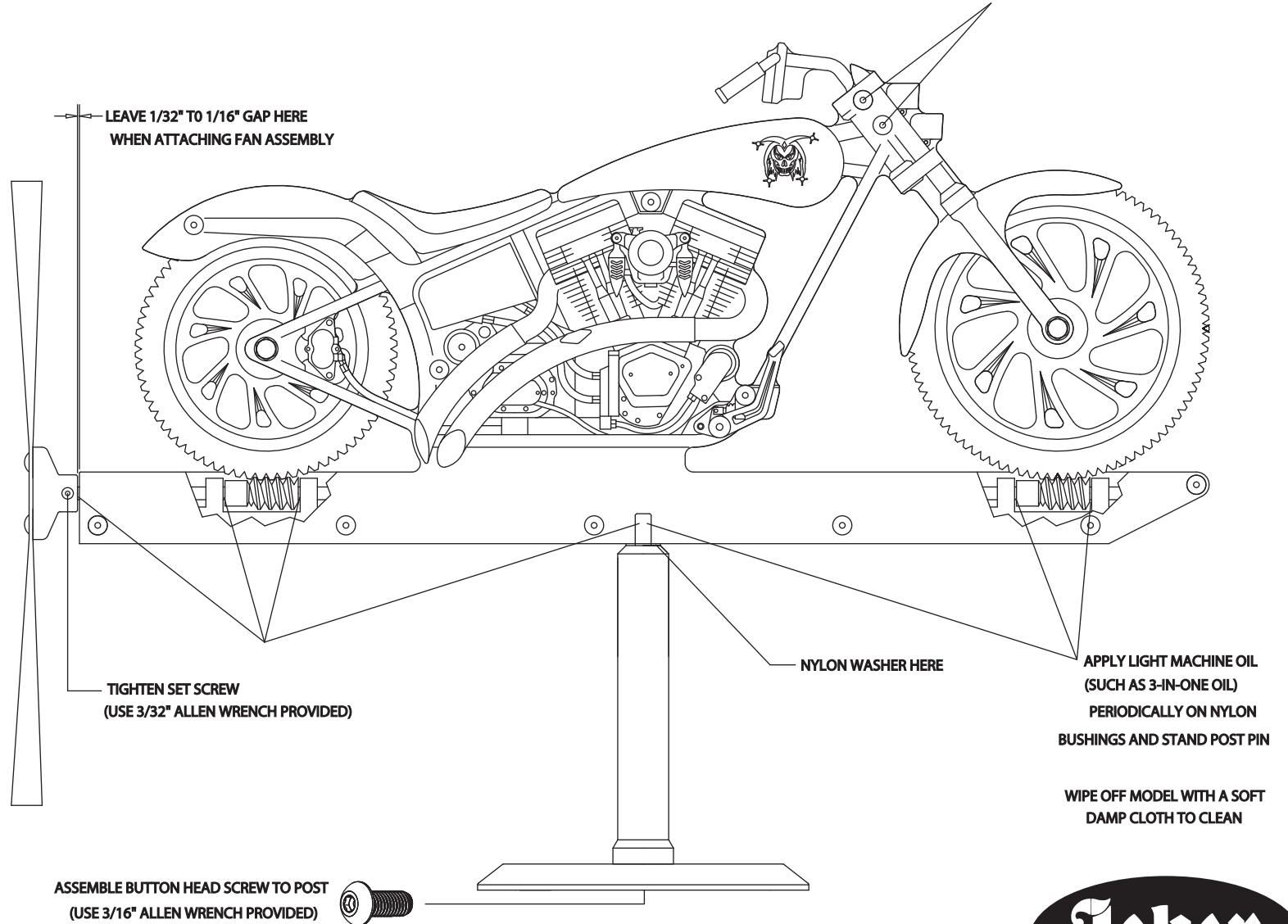

070921D 4/7/2008